



PLAT OF SURVEY

WORK ORDERED BY -  
PETER KING  
P.O. BOX 374  
FONTANA, WI. 53125

FARRIS, HANSEN & ASSOCIATES, INC.  
Engineering, Architecture, Surveying  
7 Ridgway Court P.O. Box 437  
ELKHORN, WISCONSIN 53121  
Office: (414) 723-2098  
Fax: (414) 723-5886

REVISIONS  
12/03/96

PROJECT NO.  
4646  
DATE  
11/20/96  
SHEET NO.  
1 OF 1

# PLAT OF SURVEY

## LOT 24 OF BLOCK 1

### INDIAN HILLS SUBDIVISION

LOCATED IN SECTION 14, TOWN  
1 NORTH, RANGE 16 EAST,  
WALWORTH COUNTY, WISCONSIN

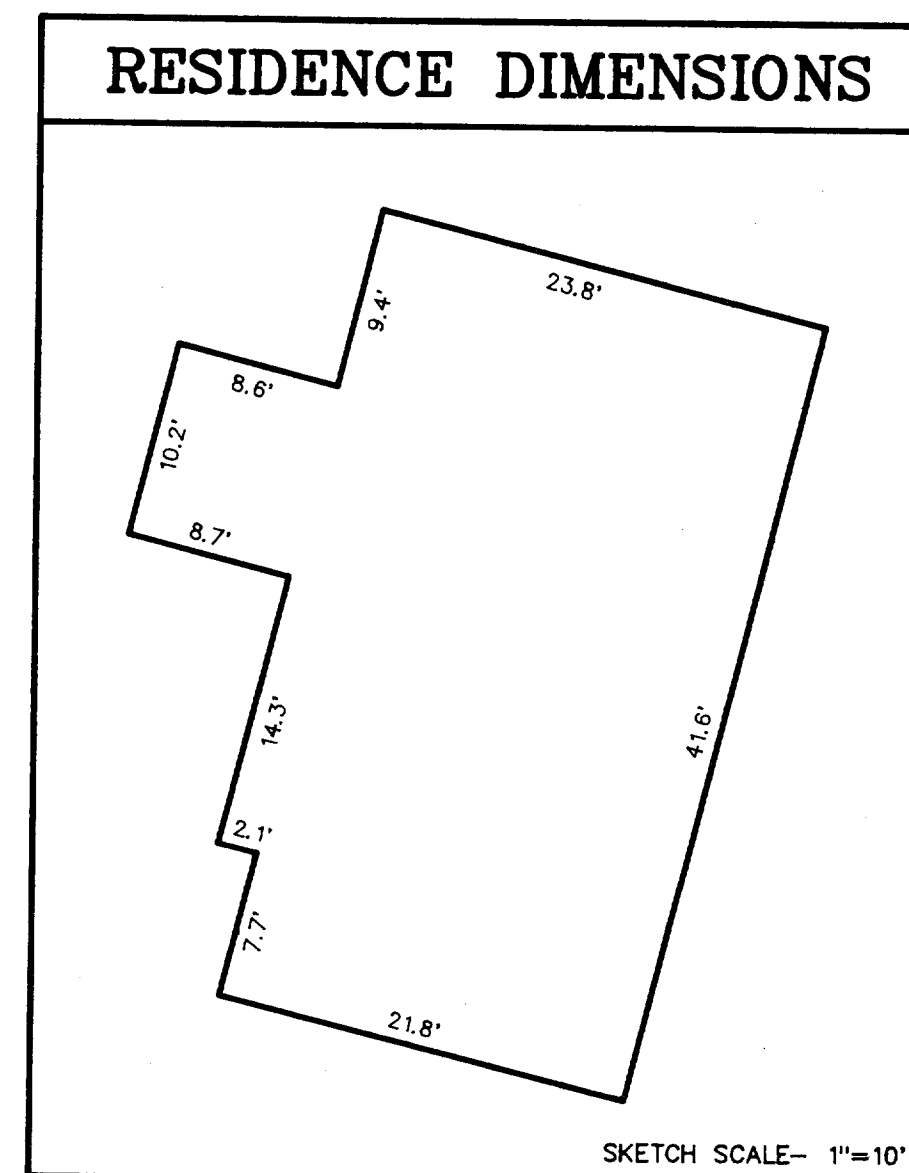

NOTE: COPIES OF THIS MAP TO WHICH THE FOLLOWING CERTIFICATE  
WILL APPLY ARE BLUE LINE PRINTS SHOWING SURVEYOR'S ORIGINAL  
SEAL AND SIGNATURE IN BLACK INK. COPIES BY ANY OTHER MEANS  
MAY HAVE ALTERATIONS WHICH DO NOT REPRESENT THE SURVEYOR'S  
WORK PRODUCT.

I HEREBY CERTIFY THAT THE ABOVE DESCRIBED PROPERTY HAS BEEN  
SURVEYED UNDER MY DIRECTION AND THAT THE ABOVE MAP IS A TRUE  
REPRESENTATION THEREOF AND SHOWS THE SIZE AND LOCATION OF  
THE PROPERTY AND ITS EXTERIOR BOUNDARIES. THIS SURVEY IS  
MADE FOR THE USE OF THE PRESENT OWNERS OF THE PROPERTY, AND  
ALSO THOSE WHO PURCHASE, MORTGAGE, OR GUARANTEE THE TITLE  
THERE TO WITHIN ONE YEAR FROM THE DATE HEREOF.

DATED: 12-03-1996

PETER S. GORDON  
S-2101  
ELKHORN,  
WI

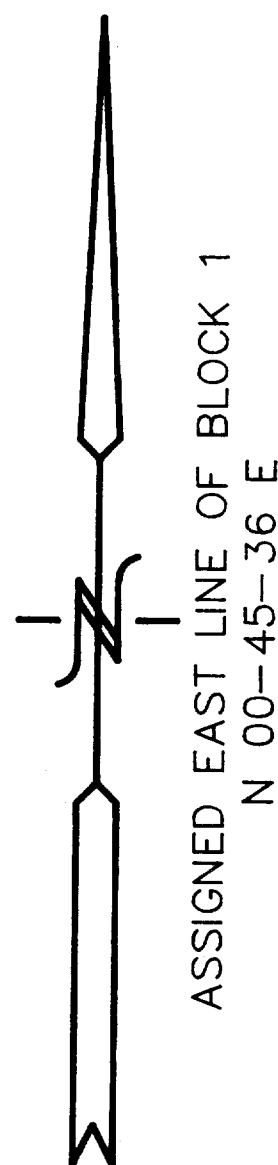
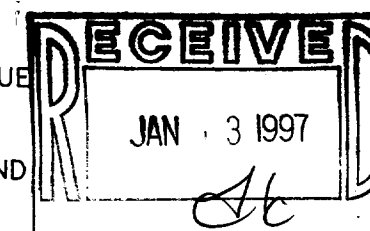
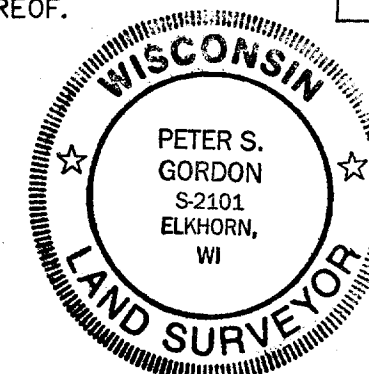

- LEGEND
- = FOUND IRON PIPE STAKE
  - = FOUND IRON REBAR STAKE
  - = FOUND CONCRETE MONUMENT
  - ⦿ = SET IRON REBAR STAKE
  - (XXX) = RECORDED AS

